

Exhibit Storage Cupboard



Scan our QR code to view assembly video

Important Information:

The upright and cross bar sections have been etched with letters and stock codes to make the assembly process as easy as possible. Please refer to these when assembling to ensure the correct sections are being connected.

Once all sections have been created, be sure to keep them in order so you know which is the back, left and right panel as this will matter when completing the final stages of assembly.

Assembling the cupboard - Back Panel



Step 1

Take the first cross bar (labelled 721E12.970E) and attach both the corner connectors by sliding into the frame and stopping once the push pin clicks into place.



Step 2

Insert the upright section (labelled 721E23.1250D) into the left hand connector. Push the upright down until the push pin clicks through the hole in the upright.



The left hand side (when positioned the right way up) will be labelled with an F at the bottom. Ensure the F on the crossbar and the F on the upright match up.



Step 3

Insert the upright section (labelled 721E23.1250C) into the right hand connector. Push the upright down until the push pin clicks through the hole in the upright.

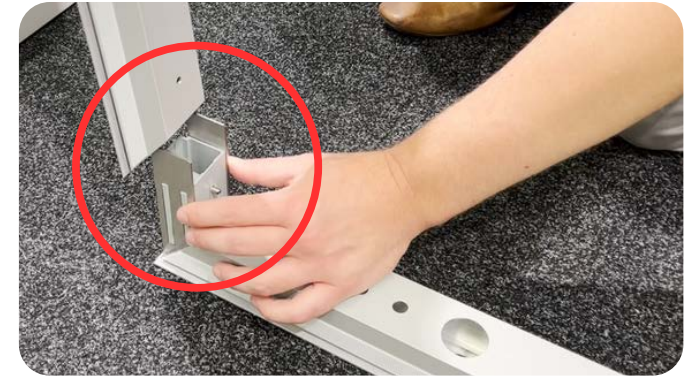

The right hand side (when positioned the right way up) will be labelled with an E at the bottom. Ensure the E on the crossbar and the E on the upright match up.



Step 4

Select the bracing bar and slot into the accessory fitting slots on both uprights, at the same level.



Step 5

Once both ends are in the accessory fitting slots, turn the bracing bar towards you to lock in place.

Repeat steps 1-5 with the remaining cross bar, uprights and bracing bar. You'll have 2 sections that look like the following:

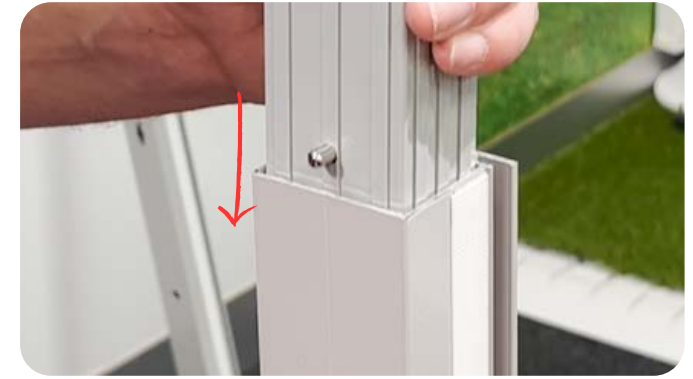
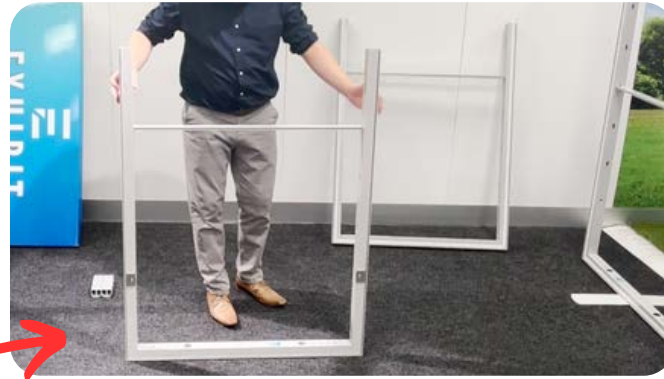

Step 6

You'll be left with 2 straight connectors. Take 1 half of the frame and push the connector until the push pin clicks through the hole in the upright frame section.



Step 7

Lift the remaining section over the top of the bottom section with has the connectors fitted. Push the top section until the push pins click into place.



Make sure the above fixings are facing the same way on the top and bottom panel sections.

Assembling the Cupboard - Left Hand Side Panel



Step 1

Take the first cross bar (labelled 721E12.970G) and attach both the corner connectors by sliding into the frame and stopping once the push pin clicks into place.

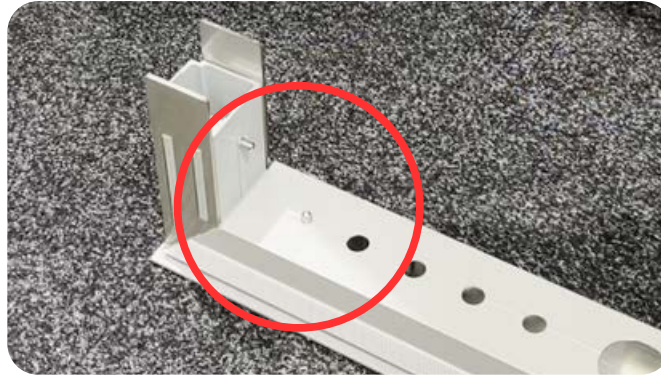

Step 2

Insert the upright section (labelled 721E23.1250G) into the right hand connector. Push the upright down until the push pin clicks through the hole in the upright.



The right hand side (when positioned the right way up) will be labelled with an K at the bottom. Ensure the K on the crossbar and the K on the upright match up.



Step 3

Insert the upright section (labelled 721E23.1250H) into the left hand connector. Push the upright down until the push pin clicks through the hole in the upright.



The left hand side (when positioned the right way up) will be labelled with an L at the bottom. Ensure the L on the crossbar and the L on the upright match up.



Step 4

Select the bracing bar and slot into the accessory fitting slots on both uprights, at the same level.



Step 5

Once both ends are in the accessory fitting slots, turn the bracing bar towards you to lock in place.

Repeat steps 1-5 with the remaining cross bar, uprights and bracing bar. You'll have 2 sections that look like the following:



One section will have the lock for the cupboard built in.



Step 6

You'll be left with 2 straight connectors. Take 1 half of the frame and push the connector until the push pin clicks through the hole in the upright frame section.



Step 7

Lift one half of the frame, and connect on top of the straight connectors. Pushing down until the push pins click through the holes in the frame, completing the left hand side panel.



All sections should be connected with the hook tape facing the same direction.

Assembling the Cupboard - Right Hand Side Panel



Step 1

Take the first cross bar (labelled 721E12.970J) and attach both the corner connectors by sliding into the frame and stopping once the push pin clicks into place.

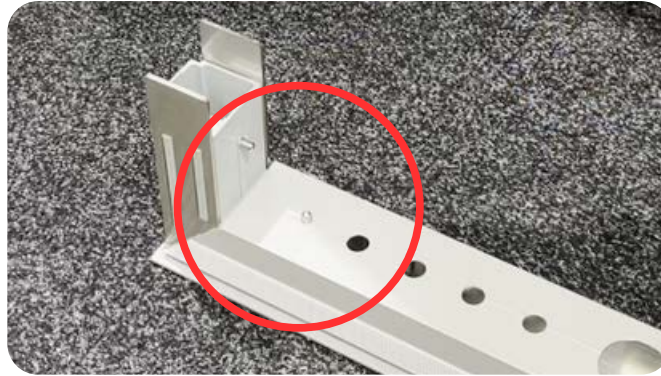

Step 2

Insert the upright section (labelled 721E23.1250M) into the left hand connector. Push the upright down until the push pin clicks through the hole in the upright.



The left hand side (when positioned the right way up) will be labelled with an R at the bottom. Ensure the R on the crossbar and the R on the upright match up.



Step 3

Insert the upright section (labelled 721E23.1250L) into the right hand connector. Push the upright down until the push pin clicks through the hole in the upright.



The right hand side (when positioned the right way up) will be labelled with a Q at the bottom. Ensure the Q on the crossbar and the Q on the upright match up.

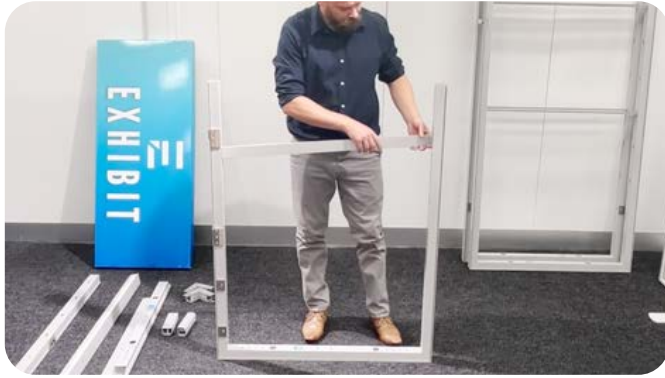

Step 4

Select the bracing bar and slot into the accessory fitting slots on both uprights, at the same level.



Step 5

Once both ends are in the accessory fitting slots, turn the bracing bar towards you to lock in place.

Repeat steps 1-5 with the remaining cross bar, uprights and bracing bar.



Step 6

You'll be left with 2 straight connectors. Take 1 half of the frame and push the connector until the push pin clicks through the hole in the upright frame section.



Step 7

Lift one half of the frame, and connect on top of the straight connectors. Pushing down until the push pins click through the holes in the frame, completing the right hand side panel.



All sections should be connected with the hook tape facing the same direction.

Assembling the Cupboard - Door



Step 1

For the door section, the corners are supplied already assembled. You'll receive x2 as pictured above.



Step 2

Take the straight connectors and add to both sides, pushing the spring pin in and pushing until the pin clicks through the hole on the upright sections.



Repeat the process for both cross bar sections.



Step 4

Making sure the hinge pins are positioned in the same way, insert the upright onto the straight connectors until the push pin clicks into place.

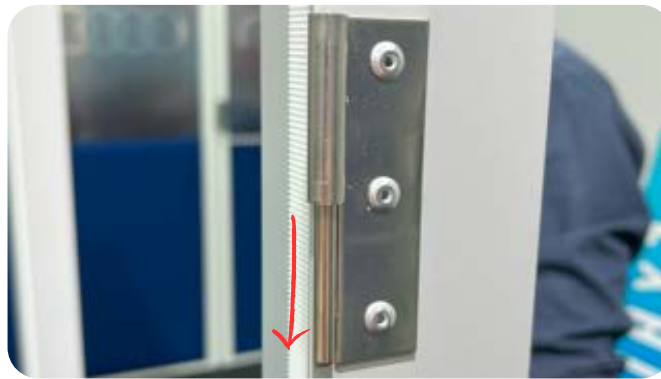

Step 5

Connect the other upright onto the straight connector until the push pin clicks through the hole on upright. Both uprights are now in place.



Make sure all hinges are running down the same side, facing the same way. All hook tape should be facing the same direction too.

Step 6

To complete the door, lower the top section onto the 2 uprights. When fully attached the push pins will click in place.

Assembling the Cupboard - Connecting all sections



We recommend laying all panels out in order as you assemble to ensure the process is easier.



Step 1
Take the panel with the lock front facing, and line up with the back panel on a 90 degree angle.



Step 2
Connect the panels with x2 screws, 1 fitted at the top and 1 at the bottom.



Step 3
Use a 5mm allen key to tighten the screw.

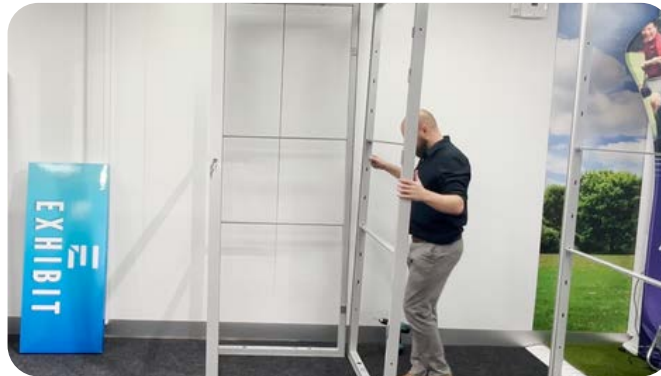

Step 4
Turn the remaining side panel to a 90 degree angle and line up with the back panel frame.



Step 5
Connect the panels with x2 screws, 1 fitted at the top and 1 at the bottom.



Step 5

The header panel is received already assembled. You'll need a ladder to fix the head panel into place between the left and right hand panels.



Step 6

Place 4 screws into the designated holes, and screw by hand just enough so the header holds in place.



Step 7

Fully tighten the header by using a 5mm allen key.



Step 8

Slide the bracing bar under the left and right side panels, ready for fixing.



Step 9

Line up the holes on the brace bar with the first hole on the cross bars of the left and right hand panels.



Use a 5mm allen key to tighten the screw.



Step 10

To attach the door, lift the door panel by connecting the door panel on the left hand side upright by lowering into place.

Assembling the Cupboard - How to attach single panels to the cupboard



Step 1

Position the panel you'd like to connect to the correct side of the cupboard. Connect into place using supplied screw and 5mm allen key.



Each panel includes x2 screws, 1 for the top and 1 for the bottom of the panel.

Assembling the Cupboard - How to attach printed panels



Step 1

The frame and graphics are fitted with hook and loop tape for easy attachment.

For the header line the corner of the graphic up with the corner of the frame and push around the edge until the panel is secured.



Step 2

Larger panels should be connected from a rolled state. Line the corner of the graphic up with the corner of the frame and unroll the panel as you work your way down the door.

