

## Modulink Monitor Bracket

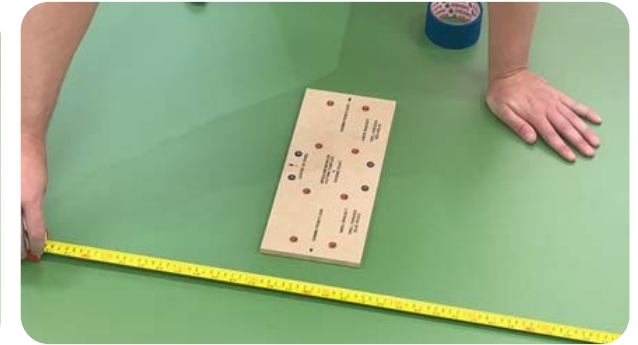

Scan our QR code to  
view the product Video



### Step 1

Position the monitor template on to the panel with the side arrows positioned 1650mm from the floor and the central arrow positioned in the centre of the panel.

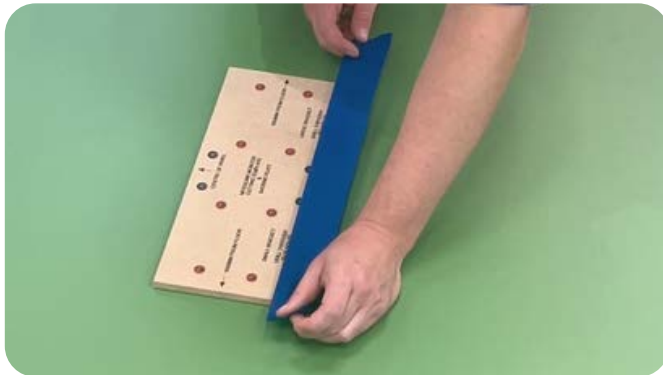

### Step 2

We recommend to use tape on the top and bottom of the template to hold in place whilst creating the holes.

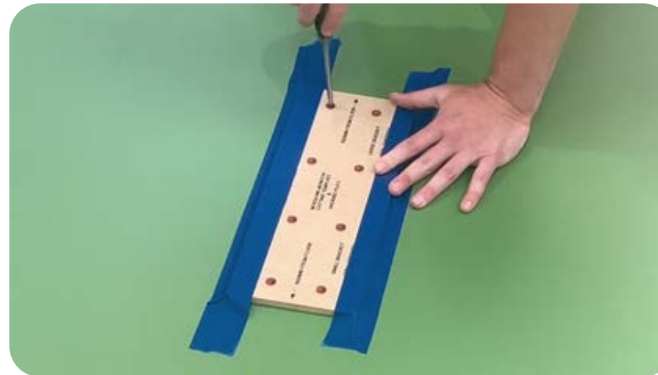

### Step 3

Once in place, push a screw driver through the 8 holes with the red circle, ensuring you go right through the board.



### Step 4

Attach the monitor bracket by feeding the provided bolts through the holes in the bracket and the panel.

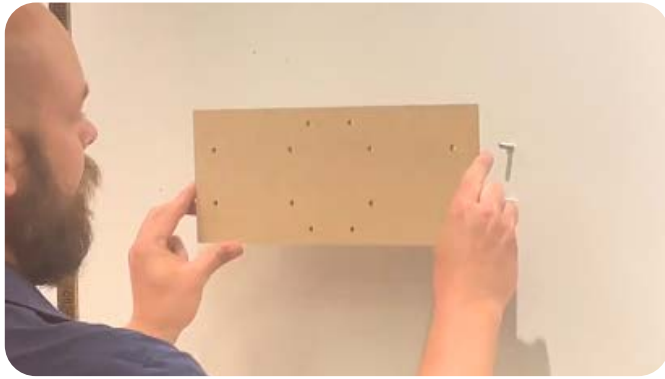

## Step 5

Take the monitor template and push through the bolts that protrude at the back of the panel. The template is also used as a backing plate.

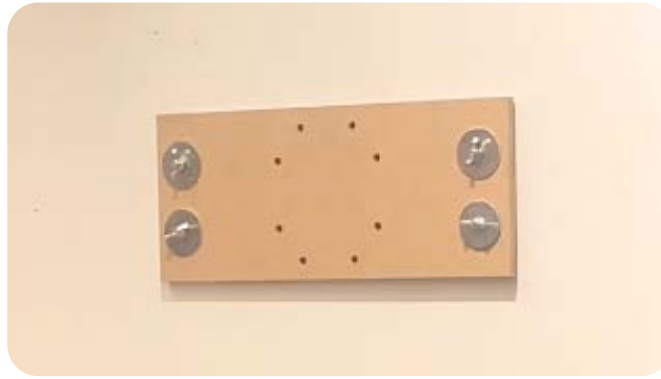

## Step 6

Finish by adding the round washer and wing nuts to secure the TV bracket and backing plate into place. Using a screw driver to securely tighten.



## Step 7

To fit the monitor arms, line the hole in the bracket arms with the holes on the back of your monitor.



## Step 8

Place the black washers under the bracket arm to line up with the holes in the monitor.



Each bracket is supplied with multiple size screws, select the correct size, add the washer and attach through the monitor arm, screwing into the back of the monitor.



## Step 9

Hook the bracket arms on to the fitted plate on the panel. Once hooked, slide in to correct position.



## Step 10

Secure the screws on the under side of the bracket arms until they grip the bottom of the monitor plate.

