

## Modulink Support Plinth



Scan our QR code to view the product Video

For the support column you'll receive the support plinth base and support plinth top.

You'll need 1 Modulink Panel to fix the support plinth to.

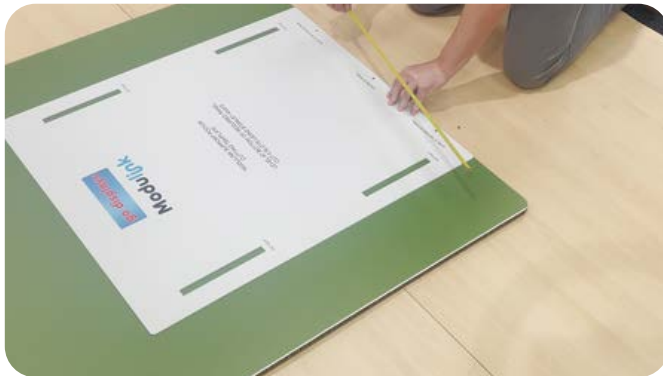
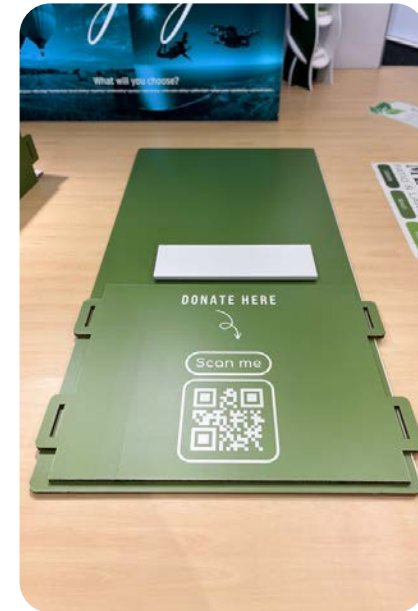

### Step 1

Position the support plinth template on your chosen Modulink Panel, lining up with the bottom edge and making sure the arrow is in the centre of the panel.



### Step 2

Secure the template onto the panel using tape along the 2 sides.



### Step 3

Use a Stanley knife to cut through the panel using the cut out guide slots. Cut all 4 slots out.



## Step 4

Turn the panel over, cutting through the same 4 sections from the back. This will allow the slots to be pushed out.

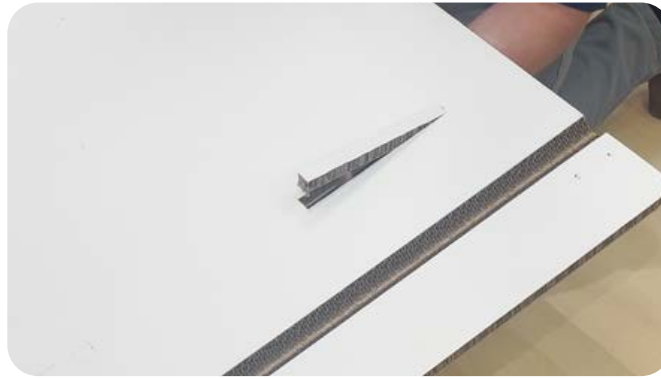

## Step 5

Remove all 4 pieces, resulting in 4 tab slots.

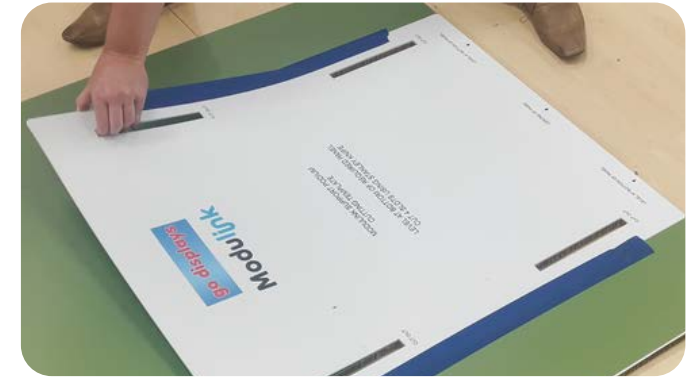

## Step 6

Turn the panel back over and remove the template.



## Step 7

Stand the just cut Modulink panel and the support plinth upright. Fit the side tabs on the plinth into the slots on the panel.



## Step 8

Complete this process on both sides so the support plinth base is flush with the front of the panel.

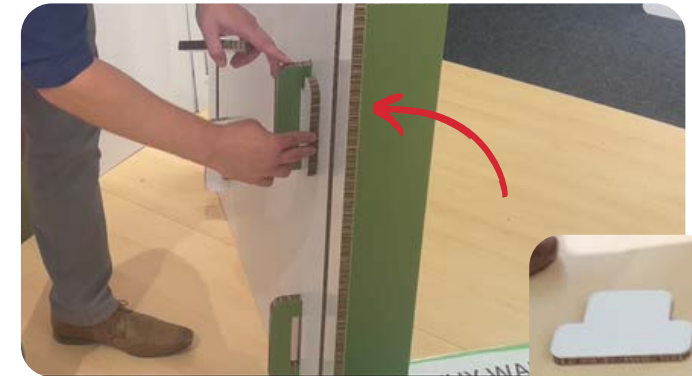

## Step 9

Take the 4 stoppers and push through the space in the tab. This will securely lock the plinth in place.



## Step 10

To complete the plinth, add the counter top which will sit directly on top of the base.

