

## Modulink Panels



Scan our QR code to view the product Video



### Step 1

Unpack the Modulink panels and position them upright and in the correct order. Doing so will make assembly quicker and easier.



### Step 2

Fold the side tabs back and position 2 panels next to each other. The tabs of both panels should line up ready for fixings.



### Step 3

Around the back of the stand, check the line up of the tabs and that the tabs are flush.

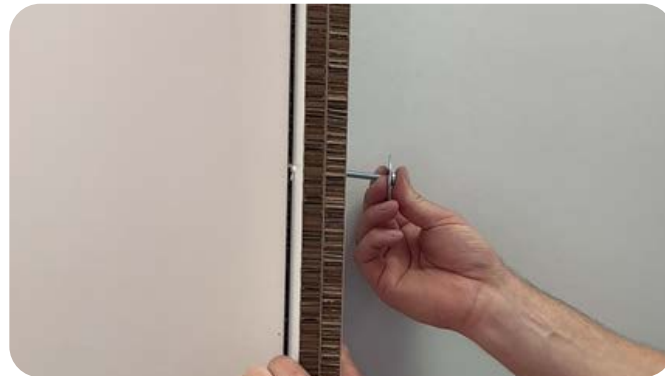

### Step 4

Thread a washer on to the screw and push through the tabs of both panels to secure them together.

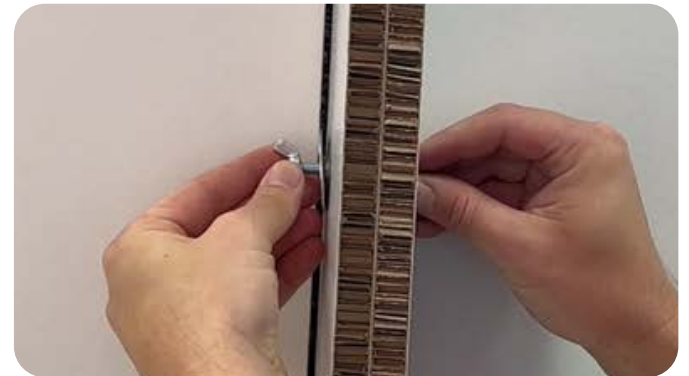

### Step 5

Once the screw has passed through both tabs, finish with another washer and wing nut.

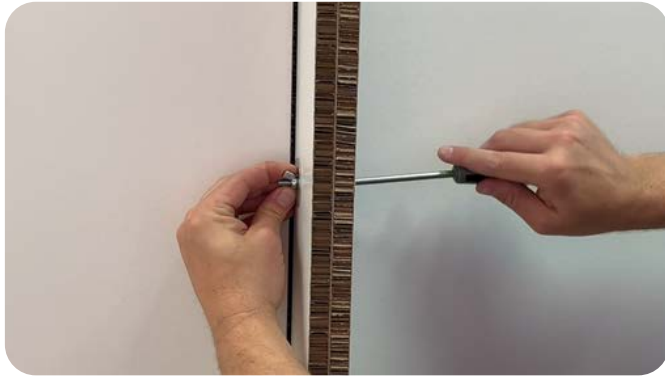

## Step 6

To ensure the fittings are securely in place, use a screw driver to tighten. Repeat process 4 & 5 on all 4 holes running top to bottom of the tabs.

Complete these steps until the full back wall has been assembled.

